

PARTS

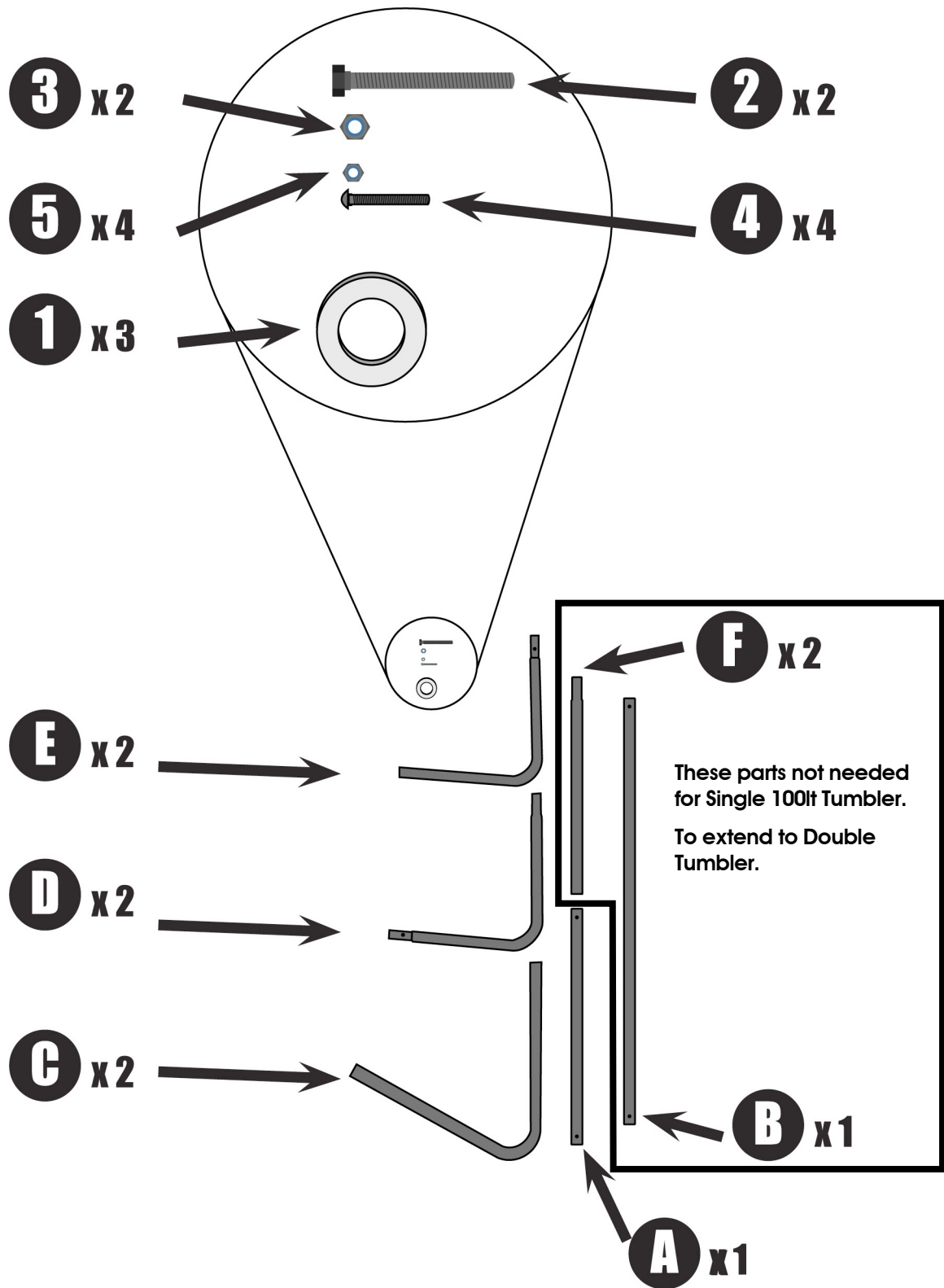

INSTRUCTIONS

1

Locate the drill hole location on 2 sides of the tank. Drill a 24mm hole at this point on both sides.

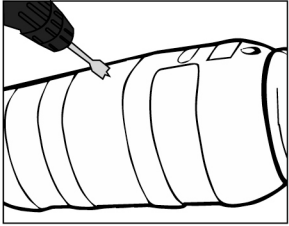

If there is no drill hole than simply measure half way down the tank (or 475mm from the bottom) and drill the 24mm hole on both sides.

2

Insert the single tumbler bar (A) through the holes till it comes out the other side. Open the lid of the tank to help guide the bar across.

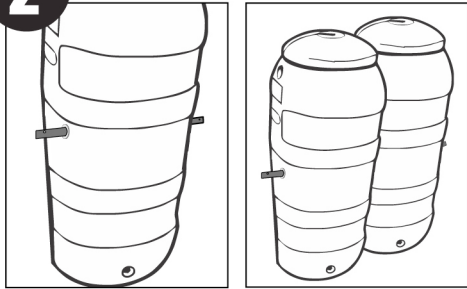

For a double tumbler place the two tanks next to each other and insert the double bar (B) through. In between the tanks place the washer (1) on the bar as it is being inserted through the tank.

3

Lay the tank on the ground. Place 2 washers (1) on the bar on each side of the tank(s).

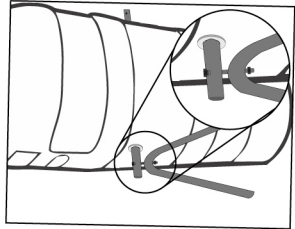

Take the large angled bars (C) and the large bolts and nuts (2 & 3) and attach them to both sides of the tank(s).

4

Take the 2 right angle bars with the male connection on both ends (D) (the thinner diameter end that fits inside the larger tube). Insert the male connection to the angler bar already attached (C). Insert both bars (D) on one side of the tumbler. Make sure you have inserted the side with the hole into part C. Line up the holes making sure the right angle bar is facing into the tumbler. Insert the small screw and nut (4 & 5) into the holes and secure in place. Repeat for the other side with parts E.

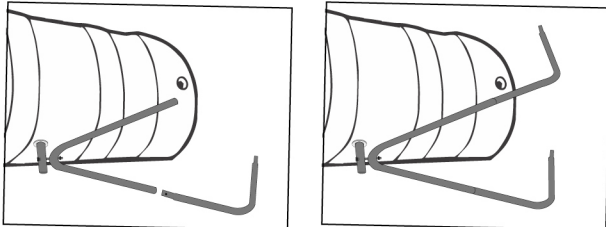

5

Join the two side of the tumbler stand together. For a double tumbler insert the extension bar (F) in between the two half of the tumbler stand.

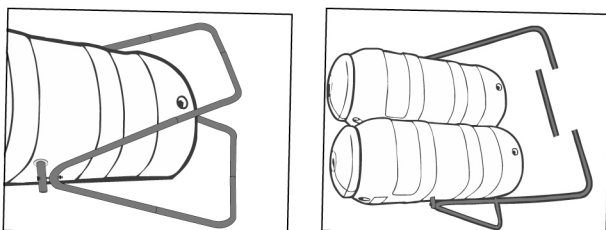

Hold the base of the tumbler and pull towards you lifting the tumbler unit upright.